



INSTALLATION INSTRUCTIONS

Accessory

**SPORT SUSPENSION
08W60-S5T-100**

Application

2005 CIVIC SI

Publications No.

All 27952

Issue Date

SEP 2004

PARTS LIST

Right front damper assembly

Left front damper assembly

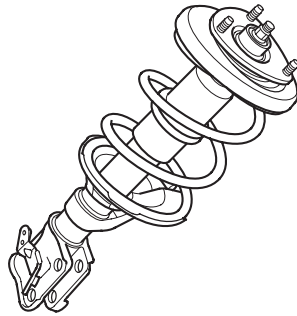

Right rear damper assembly

Left rear damper assembly

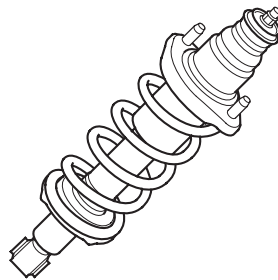

Trunk Emblem

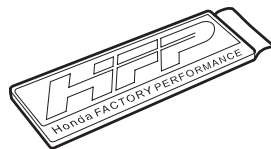

Dash Emblem

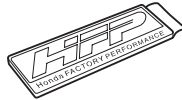

TOOLS AND SUPPLIES REQUIRED

10 mm and 12 mm Combination wrenches

17 mm and 19 mm Sockets

Ratchet

Torque wrench

Shop towels

Utility knife

Tape measure

Isopropyl alcohol

Ball joint remover, 28 mm
(T/N 07MAC-SL00200)

Ball joint thread protector
(T/N 07AAF-SDAA100)

INSTALLATION

Customer Information: The information in this installation instruction is intended for use only by skilled technicians who have the proper tools, equipment, and training to correctly and safely add equipment to your vehicle. These procedures should not be attempted by "do-it-yourselfers."

NOTE:

- Inflate the tires to the specified air pressure.
- These instructions show the left damper assembly being installed; the same procedure applies to installing the right damper assembly.
- These dampers are designed to be used exclusively with this model and should not be used with other models.
- The dampers for the left and right sides are different. Be sure to note the "L" and "R" markings on the dampers for the proper installation.

Removing the Front Damper

1. With the vehicle on a rack, remove all four wheels.
2. Remove the cotter pin from the tie-rod end ball joint, and remove the nut.

**BALL JOINT
THREAD PROTECTOR
(T/N 07MAC-S100200)**

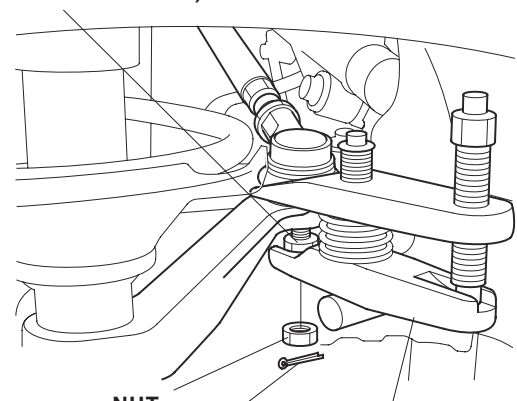

NUT

COTTER PIN

**28 MM BALL
JOINT REMOVER
(T/N 07MAC-S100200)**

3. Using ball joint remover tool, disconnect the tie-rod end from the steering arm of the damper assembly.

- Remove the wheel sensor harness bracket, and the brake hose bracket from the damper. Do not unplug the wheel speed sensor connector.

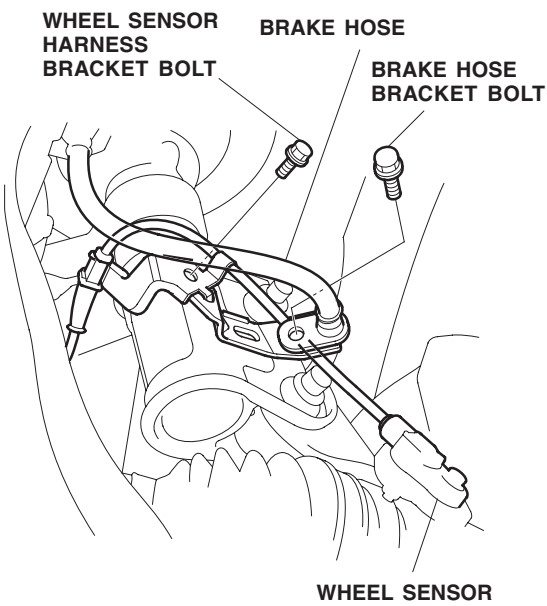

- Remove the damper pinch bolts. Note the position and direction of the pinch bolts and remove the bolts.

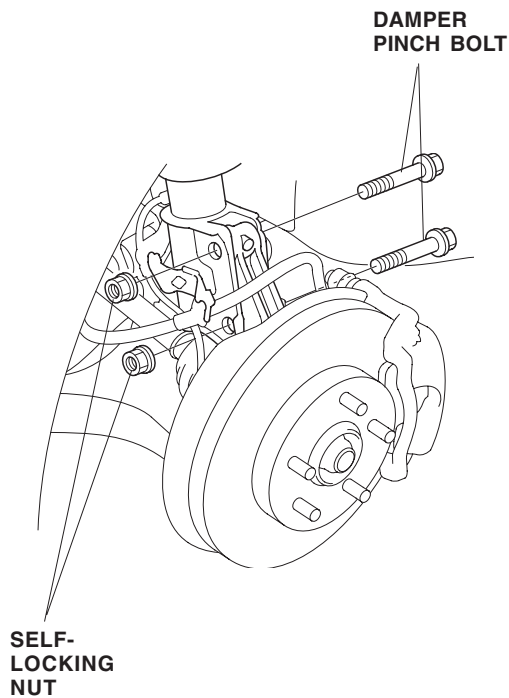

- While supporting the damper assembly, remove the nuts that secure the upper flange; lower the control arm, and remove the damper assembly.

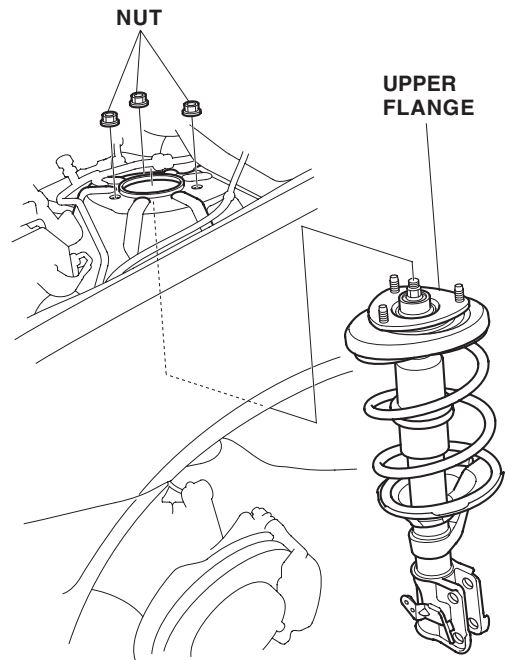

Installing the Front Damper

- Install the new left front damper. Turn the damper so the "L" mark faces toward the outside.

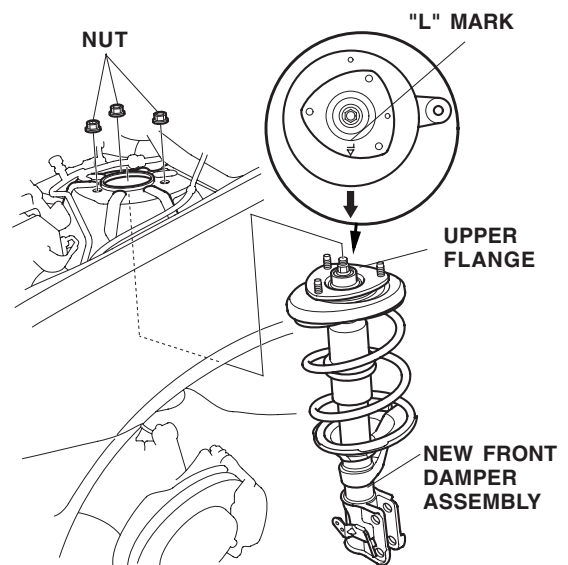

- Position the bottom of the damper onto the knuckle, and install the pinch bolt from the rear of the vehicle.

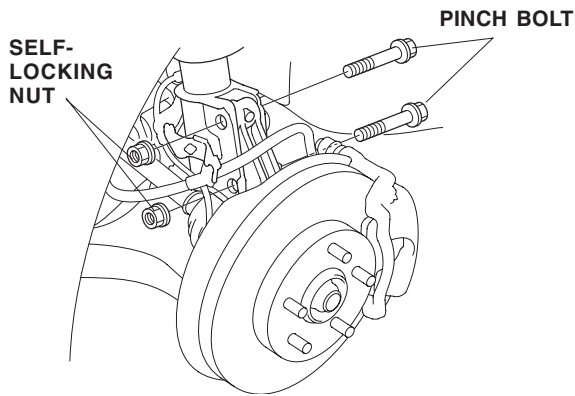

- Install the self-locking nuts onto the damper pinch bolts, but don't tighten them yet.
- Load the suspension with the weight of the vehicle before final torque of the components. Do not jack against the flat portion of the lower control arm. Lifting the arm in this area may damage the control arm.

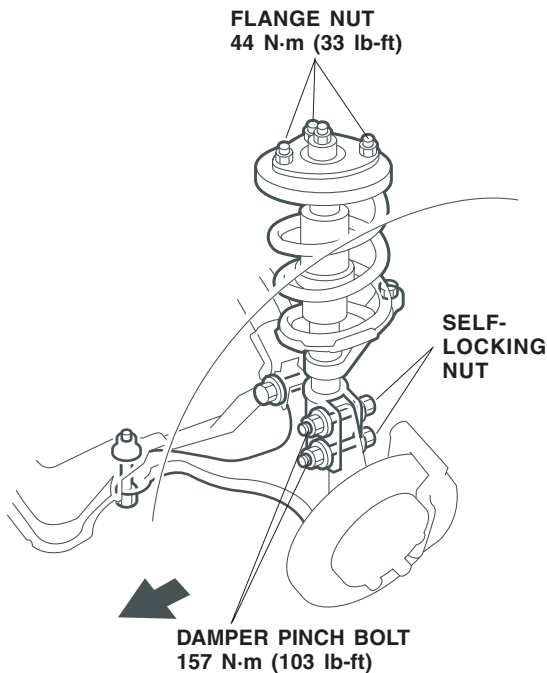

- Torque the three flange nuts on top of the damper to 44 N·m (33 lb-ft) and torque the two damper pinch bolts to 157 N·m (116 lb-ft).

- Reconnect the tie-rod end to the steering arm of the damper. Torque the mounting nut to 43 N·m (32 lb-ft). Install a new cotter pin to secure the tie-rod end mounting nut.

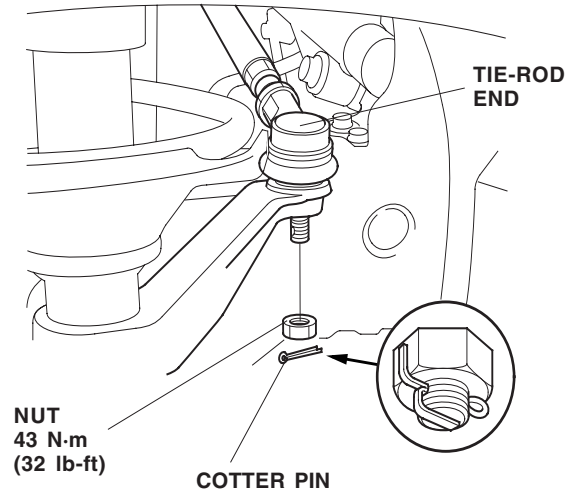

- Reinstall the brake hose and wheel sensor harness brackets. Torque the brake hose bracket bolt to 22 N·m (16 lb-ft). Torque the wheel sensor harness bracket bolt to 9.8 N·m (7.2 lb-ft).

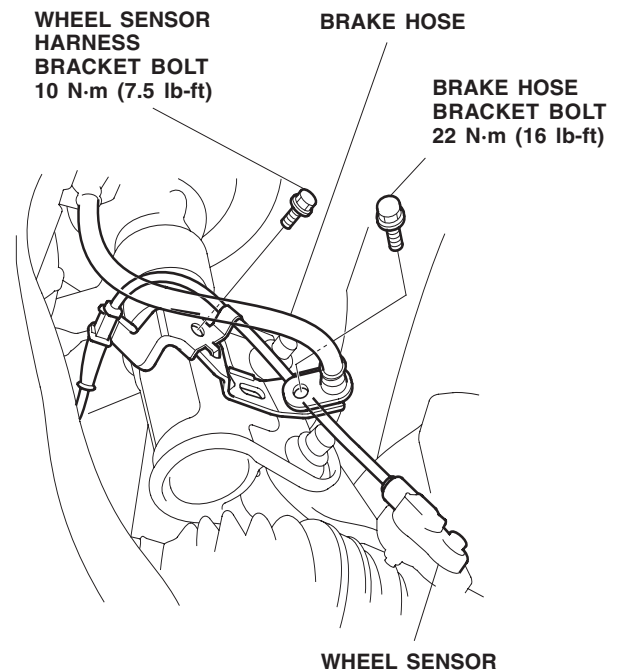

- Repeat steps 2 through 13 to install the right front damper assembly.
- Install the front wheels and torque the wheel nuts to 108 N·m (80 lb-ft).

Removing the Rear Damper

16. Remove the flange bolt from the lower mount of the damper.

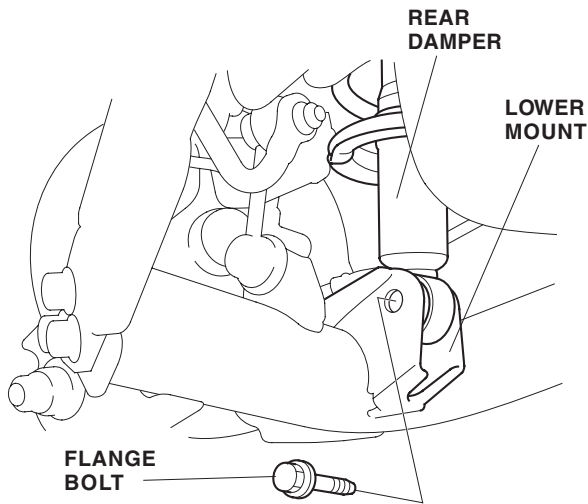

17. Inside the cargo area, remove the clip that secures the left rear bulkhead cover. Using a flat-tip screwdriver wrapped with a shop towel, pry out on the top of the bulkhead cover to release the 7 tabs. Remove the right rear bulkhead cover using the same procedure.

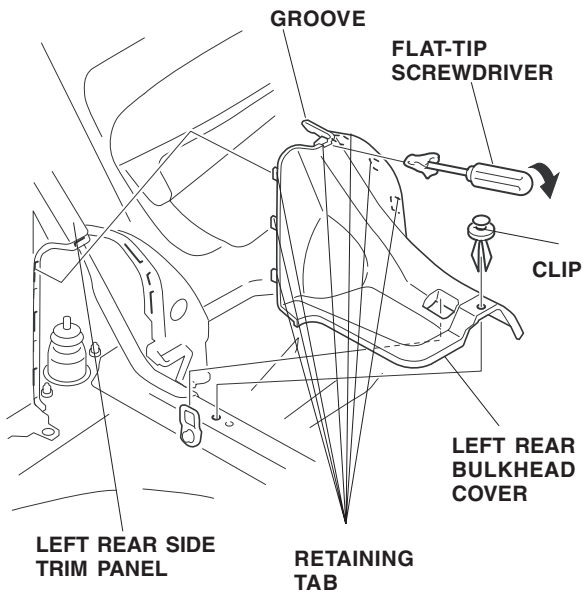

18. From inside the trunk, remove the flange nuts from the upper mount of the rear damper.

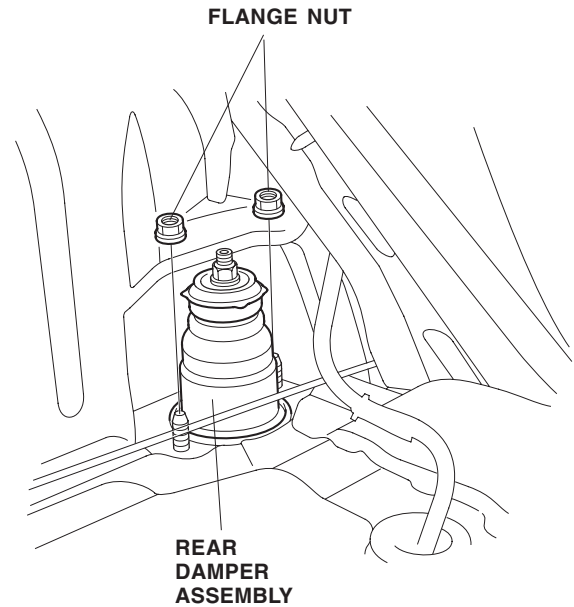

19. Remove the damper assembly from the body.

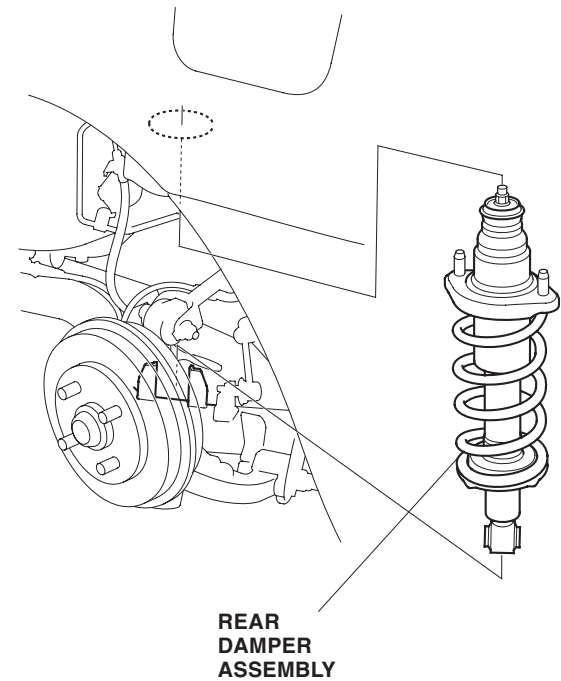

Installing the New Rear Damper

20. Install the new left damper with the small hole on the flange facing toward the front and inside of the vehicle.

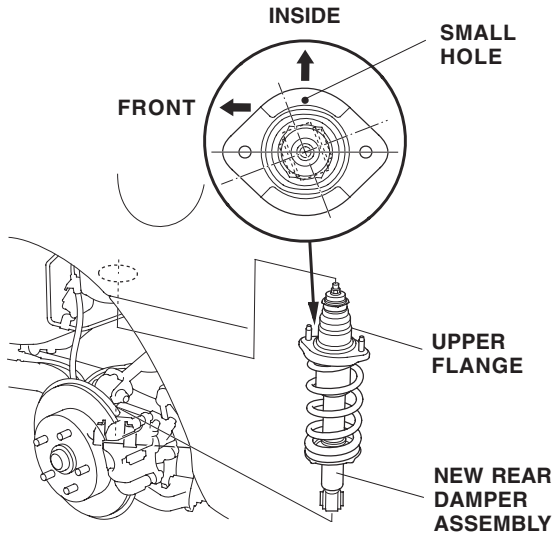

21. Install the flange nuts onto the top of the damper, but don't tighten them yet.

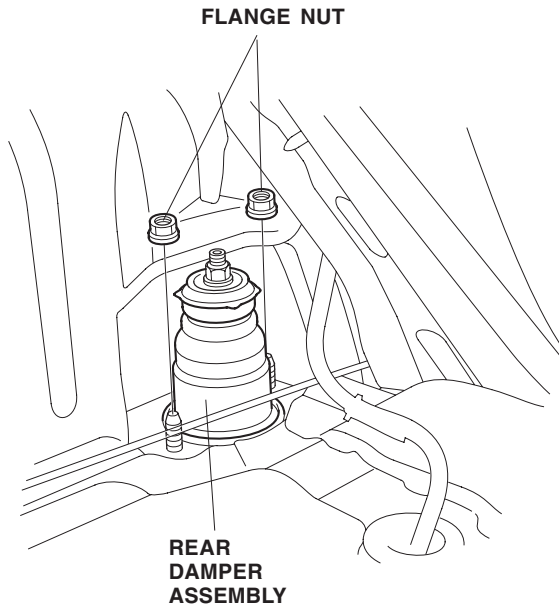

22. Install the flange bolt to the lower mount of the damper, but don't tighten the flange bolt yet.

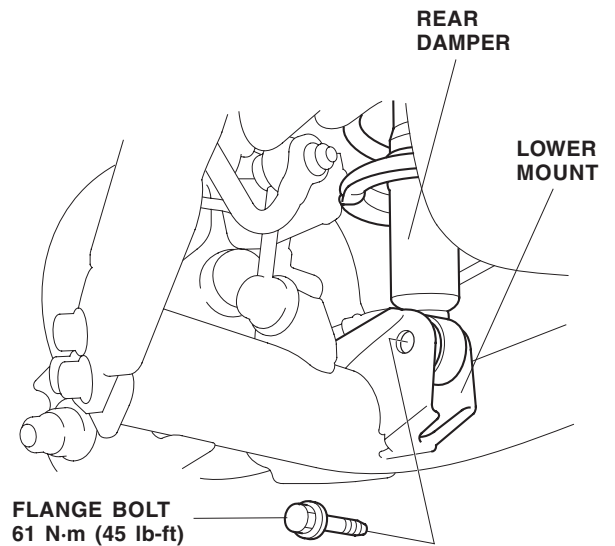

23. With the suspension loaded with the weight of the vehicle, torque the two flange nuts on top of the damper to 59 N·m (43 lb-ft) and torque the damper lower mount flange bolt to 61 N·m (45 lb-ft).

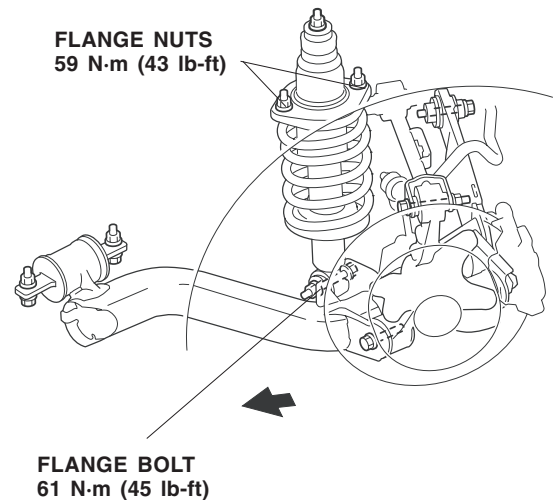

24. Repeat steps 16 through 23 to install the right rear damper assembly.
25. Install the rear wheels and torque the wheel nuts to 108 N·m (80 lb-ft).
26. Check the wheel alignment and adjust as necessary.
27. Check the headlight aiming and adjust as necessary.

Installing the Emblems

There are two different size emblems and specific installation instructions for each one:

- Exterior Emblem 25.4 x 84.1 mm (1.0 x 3.3 inches)
 - Interior Emblem 19.0 x 60.3 mm (.75 x 2.4 inches)
28. Using a shop towel dampened with isopropyl alcohol, clean the body surface where the exterior emblem will attach.
 29. Using the lower left corner style lines of the trunk as a guide, position two pieces of masking tape as shown.

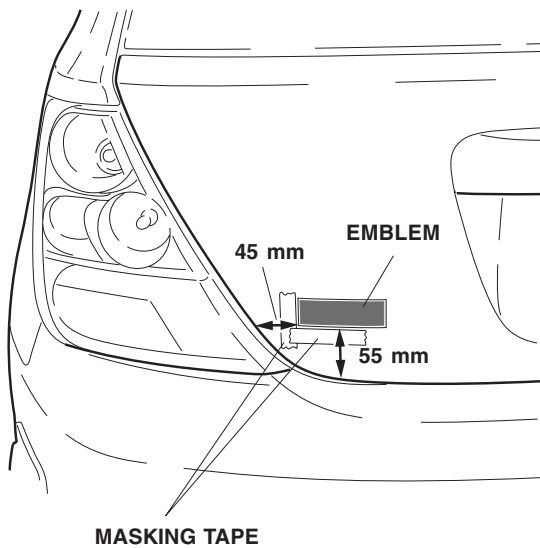

30. Remove the adhesive backing from the emblem, and position the exterior emblem on the trunk while using the masking tape as the horizontal and vertical guides.
31. Firmly press the emblem into position and remove the masking tape.

32. Inside the vehicle, clean the center console area shown with soap and water. Be sure the area is completely dry before installing the emblem.
33. Using the measurement shown, attach two pieces of masking tape to the console.

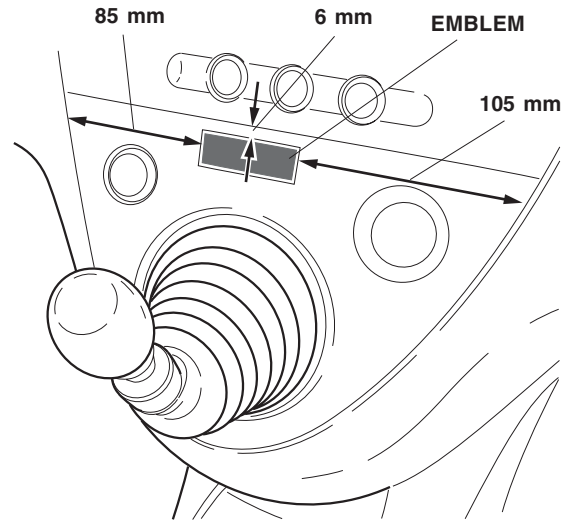

34. Remove the adhesive backing from the emblem, and position the interior emblem on the center console while using the masking tape as the horizontal and vertical guides.
35. Firmly press the emblem into position and remove the masking tape.

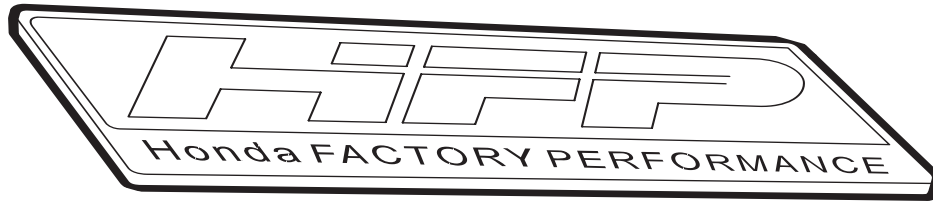

Installation Certification

I certify that a Civic Factory Performance System sports suspension has been installed on this vehicle following Honda specifications:

VIN

Technician

Date

Dealer Number

Dealer Sales Copy

Customer Copy

AHM copy